

ROLLERDRIVE EC310 IP66

Product Description

- Internal commutation electronics (brushless motor)
- 7 gear stages
- Constant conveyor speed
- Energy recovery in braking (see also p 199)
- Electronic holding brake
- Motor cable with 5-pin snap-in plug, without the need for complex screwing

Technical Data

General technical data

Mechanical power	32 W
Max. noise level	50 dB(A) (application-dependent)
Possible static bearing load	700 N (Conveyor speed 0,98 m/s)
Slave side: PolyVee female thread/female thread	900 N (Conveyor speed 0,65 m/s)
	1100 N (Conveyor speed ≤ 0,44 m/s)

Electrical data

Rated voltage	24 V DC
Temporarily permissible voltage range	18 to 28 V DC
Idle current	0.4 A
Rated current	2.0 A
Max. start-up current	5.0 A
Permissible voltage undulation	< 3 %
Protection rate	IP66

Dimensions

Tube diameter / Wall thickness	50 x 1.5 mm; 51 x 2 mm
Max. reference length	1,500 mm

Ambient conditions

Ambient temperature in operation	0 to +40 °C
Ambient temperature during transport and storage	-30 to +75 °C
Max. air humidity	85 %, non-condensating



Sealed RollerDrive with a long service life for operation in wet areas

Product Selection

The following tables provide an overview of the possible versions.

Gear ratio	Max. conveyor speed m/s	Rated torque Nm	Start-up torque Nm	Zero motion hold Nm
16:1	0.98	0.81	1.95	0.64
20:1	0.79	1.01	2.44	0.80
24:1	0.65	1.21	2.92	0.96
36:1	0.44	1.82	4.38	1.44
48:1	0.33	2.42	5.85	1.92
64:1	0.25	3.23	7.80	2.56
96:1	0.16	4.84	11.69	3.84

**Gear stage
versions**

Tube material	Stainless steel
Motor shaft	11 mm with hex and thread M12 x 1
Motor shaft material	Stainless steel
Tube sleeve	PVC hose 2 / 5 mm, PU hose 2 mm, rubber coating 2 to 5 mm
Length of motor cable	0.48 m

Further versions

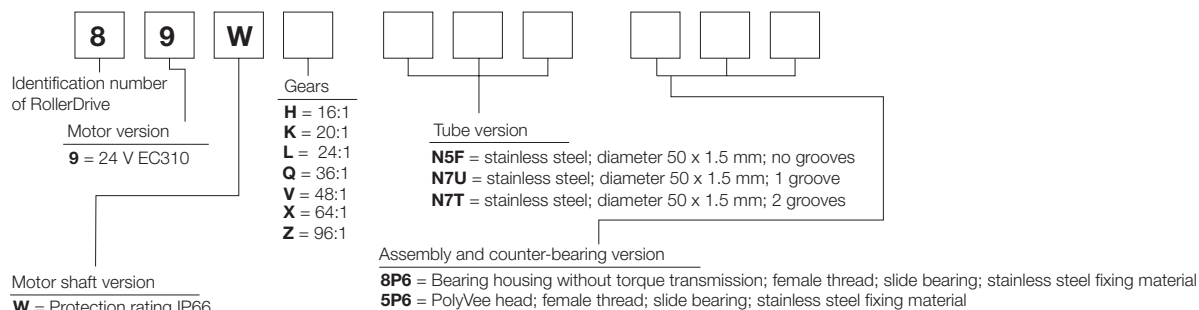

**Reference
number**

Not all criteria can be combined: please ask about tube coatings

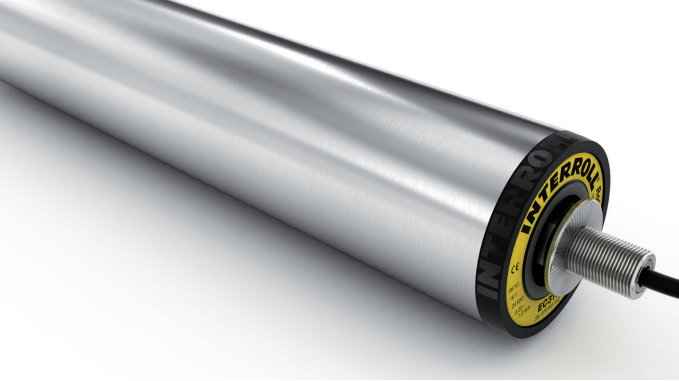

ROLLERDRIVE EC310 IP66

Dimensions and Connections

Dimensions

The dimensions depend on the shaft and counter bearing selected. The reference length/ordering length RL does not have any reference edges on the conveyor roller and can therefore not be shown. The installation (EL) corresponds to the clearance between the side profiles. All dimensions in mm.

Motor side

Slave side

Female thread M8

11 mm hex M12 x 1

Straight

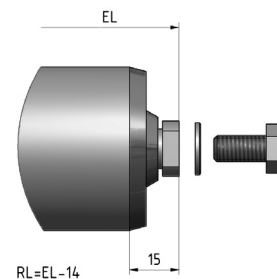
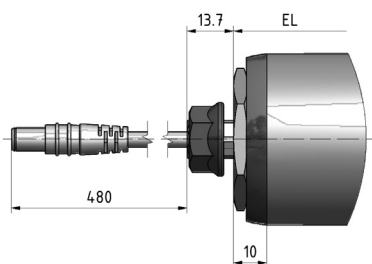

2 grooves

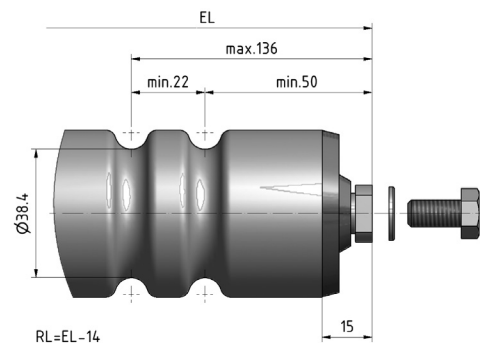

PolyVee Head

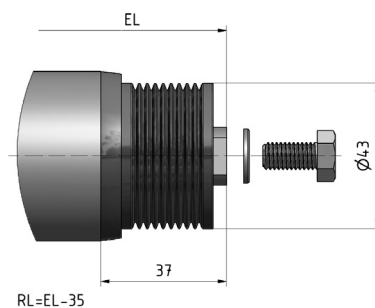

Sealed RollerDrive with a long service life for operation in wet areas

Motor plug assignment:

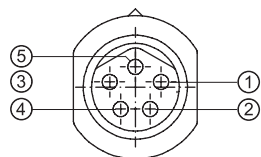

Motor plug

Pin	Colour	Line
1	Brown	+24 V DC
2	White	Direction of rotation
3	Blue	Earth
4	Black	Fault output
5	Grey	Analogue speed input