



# POLYMER CONVEYOR WHEELS 2370

Double ball race with spindle

## Product Description

- Simple to install
- Low-noise operation
- Made of impact-resistant polymer
- Double ball race
- Floating fixing on the profile
- Shaft pin, zinc-plated, M8 15 mm
- 2 mm slit for screwdriver
- Based on Platform 1100

## Technical Data

General technical data	
Material	Polypropylene
Static load capacity	50 N
Dynamic load capacity	100 N

## Product Selection

Version	Bearing	Colour	Weight	Reference number
Without flange	Steel balls on a zinc-plated steel pin	Black	45 g	2371
	Stainless steel balls on stainless steel pins	Grey	45 g	2373
With flange	Steel balls on a zinc-plated steel pin	Black	49 g	2370
	Stainless steel balls and stainless steel pins	Grey	49 g	2372

## Dimensions

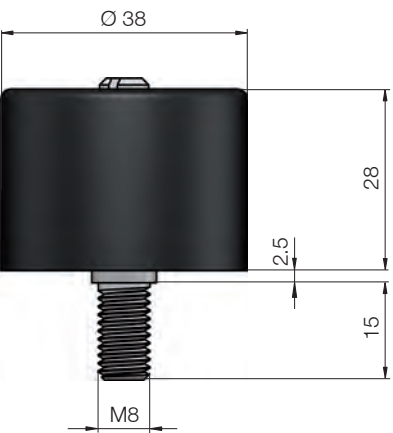

Fig.: Dimensions without flange

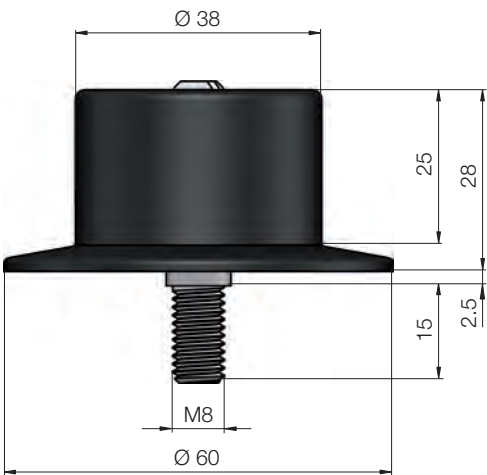

Fig.: Dimensions with flange