

4413



4413 Folding table

Functionality, robustness and durability are the attributes that distinguish this folding table. The model is very easy-to-handle: rather than having to follow a complex set of instructions, staff can simply proceed intuitively.

Frame

The foldable sections of the table are shaped like a double T, featuring two central columns and two lateral extensions each (Ø 30 x 2 tubular metal). The mechanism can be locked through an angled wire bracket that is suspended in a (patented) smooth-running plastic rail (push-button operation). Fold-back stacking devices, stacking spouts have been welded to the frame on the inside and provided with white plastic caps.

Frame surfaces

Standard version: power-coated in black, optionally powder-coated according to the BRUNE® collection or chrome-plated.

Table tops

Plate C: 30 mm thick, high-quality multi-layer plywood plate E1, top surface optionally covered with HPL plastic or wood veneer according to the BRUNE® collection. Lower surface white HPL or beech veneer. Straight edge, 2 mm thick, in material to match table top (plastic for plastic, veneer for veneer).

Plate D: 30 mm thick, 28 mm thick high-quality multi-layer plywood plate E1, top surface optionally covered with HPL plastic or wood veneer according to the BRUNE® collection. Lower surface white HPL or beech veneer. Edge with solid beechwood edge band, smooth finish, 9 mm thick.

Plate E: 30 mm thick, 28 mm high-quality multi-layer plywood board E1, coated in high-pressure laminate (HPL) or veneer according to the BRUNE® collection. Lower surface: white HPL or beech veneer. Edge: solid beech edge band, crowned, 9 mm thick.

Plate H: 20 mm thick, high-quality multilayer plywood plate E1, top surface covered with HPL according to the BRUNE® collection. Lower surface white HPL. Edge with solid beechwood edge band, smooth finish, 65 mm high, galvanized corners, 15 mm thick.

Alternative option: Plates C, D + E can also be delivered with a lightweight board made from poplar plywood (replacing the E1 board).

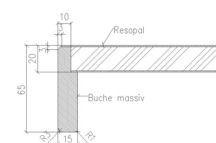
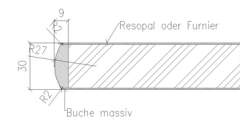
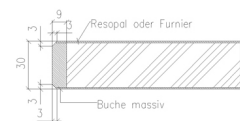
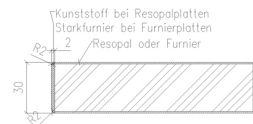

Veneer finish

Real wood veneer from the BRUNE® collection comes as a standard varnished with a low solvent content water-based lacquer, optionally stained to the BRUNE® collection.

HPL surfaces

Resopal®-HPL from the BRUNE® collection.

Gliders

Plastic gliders

Dimensions

| | | | | |
|----------------|--------|---------|---------------------|-------|
| Table heights: | | 75 cm | Plate C + D + E + R | |
| | | 74 cm | Plate H | |
| Table sizes: | min. | 60 cm | | |
| | max. | 180 cm | | |
| Weights: | 120x60 | 22 kg | trapez | |
| | 140x60 | 24 kg | 140x70x61 | 20 kg |
| | 160x60 | 26,5 kg | 160x80x69 | 24 kg |
| | 120x70 | 24 kg | | |
| | 140x70 | 27 kg | | |
| | 160x70 | 30 kg | | |
| | 120x80 | 28 kg | | |
| | 140x80 | 30 kg | | |
| | 160x80 | 33 kg | | |
| | | | | |

Certificates



TÜV Certificate

ISO 9001:2015



Quality management in accordance
with DIN EN ISO 9001

ISO 14001:2015



Environmental management system in
accordance with DIN EN ISO 14001

4413



Table



Table



Details