

Dx Geomagic® Design X™

The Ultimate
3D Scan-to-CAD Solution

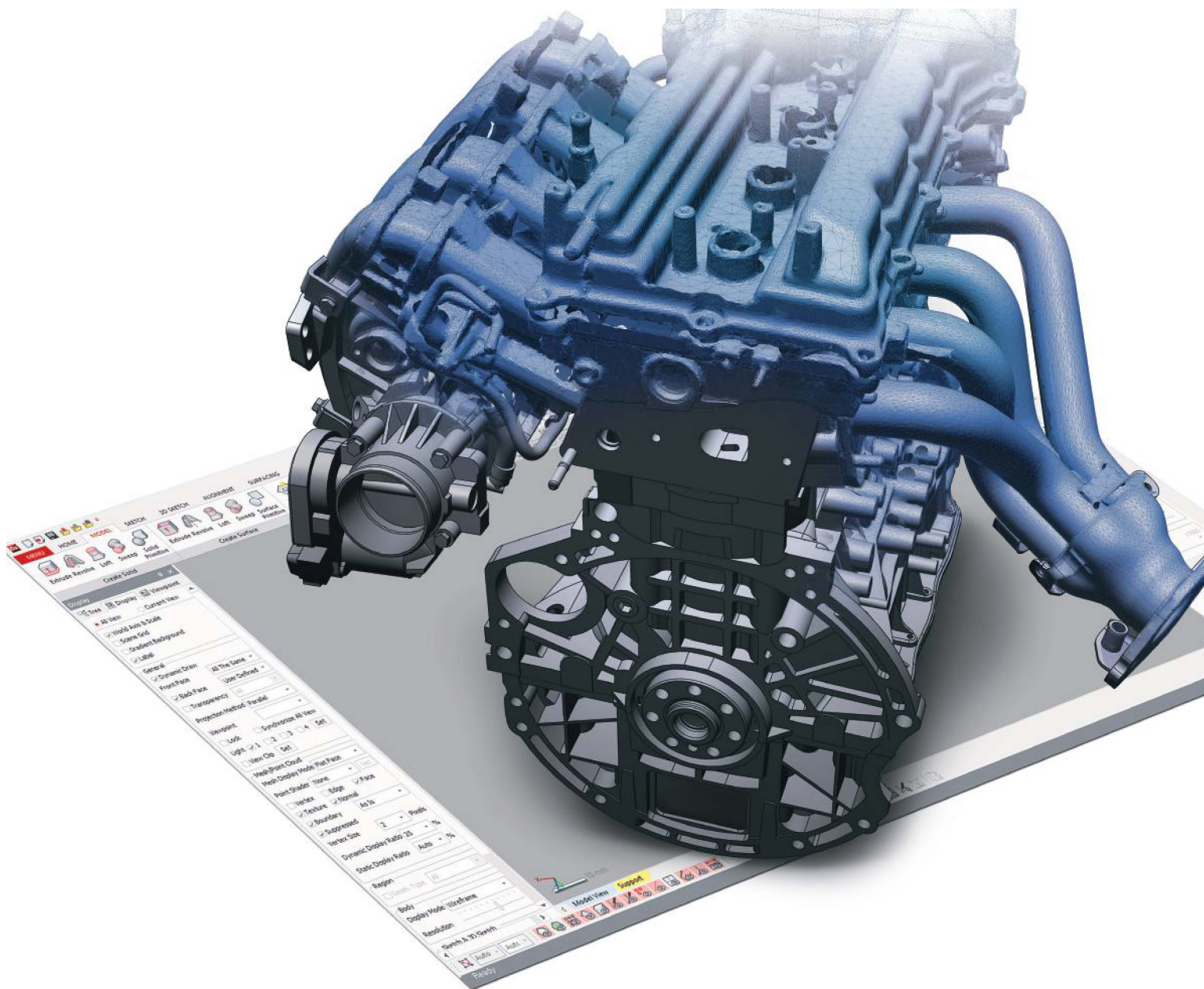

 **3D SYSTEMS®**



Geomagic® Design X™

Geomagic Design X, is an advanced software for reverse engineering. It combines 3D modelling functions like in CAD software with data processing obtained from the scanning process. Based on data from the eviXscan 3D scanner user can create fully parametric and editable models in a format compatible with used CAD software.

Design using the capabilities of 3D scanning

Instead of starting from a blank screen, start editing the data collected from existing objects – integrate 3D scans into the design process. Geomagic Design X is the easiest way to create fully editable and functional CAD models based on STL files.

Shorter time-to-market

With Geomagic Design X, the time from the emergence of an idea to the finished project can be reduced from months to days. Scan prototypes, existing parts, tools and other related objects to create a CAD design of the product – up to eight times faster than with the manual modeling from scratch.

Multiply your CAD options

Work more quickly and with more flexibility through the use of 3D scans in the design process. Geomagic Design X is the perfect complement to design tools in every system. Geomagic Design X is compatible with the most popular CAD environments: Autodesk Inventor, SolidWorks, Siemens NX®, Solid Edge, Creo® PTC and Pro / ENGINEER..

Improve real world

Many new creative projects are inspired by already existing objects. It is simple and fast to scan an object and enter it into your CAD program. Visualize its construction and dimensions. Modify it according to your needs and the current objectives of your project or create CAD documentation for objects where it does not exist

Make impossible, possible

Create products that could not be designed without reverse engineering. Customize parts that require a perfect fit with the human body. Create components that integrate perfectly with existing products. Recreate complex geometry that can not be designed or measured any other way

Reduce Costs

Stop wasting time and money during the design and production process. Match strictly the CAD model to the scanned object at the design stage. You will reduce production costs, avoid costly errors associated with improper fit of the prototype to the other elements.



CAD modeling has never been so easy! Thanks to use of 3D technology

Works with most popular CAD systems

Geomagic Design X is fully compatible with leading CAD programs, including: Autodesk Inventor, SolidWorks, Siemens NX®, Solid Edge and PTC Creo®. Thanks to unique technology (LiveTransfer) you can export complete models with the history tree, which significantly accelerates the design process by reducing the time needed to start production.

Powerful and Flexible

Geomagic Design X was designed for efficient processing of data obtained during 3D scanning. A with a unique combination of innovative software functions such as precise mapping of surface, automatic merge into CAD model from cloud of points, processing and edition of mesh, simplifies the work. In practice, such solutions can make a final production model from almost any 3D scans

A tool designed for demanding designers

Geomagic Design X has a unique combination of functions for a design process requiring models – a completely new level of effectiveness. The software supports scanning billions of points which allows you to correct problems with the data; you can skip cleaning scans and immediately start creating CAD models

Works Like Your CAD Software

If you can design in CAD, you can start using Geomagic Design X right away. It's fully-updated user interface and workflow tools make it easier than ever to quickly and accurately create as-designed and as-built 3D CAD and model data.

Workflows

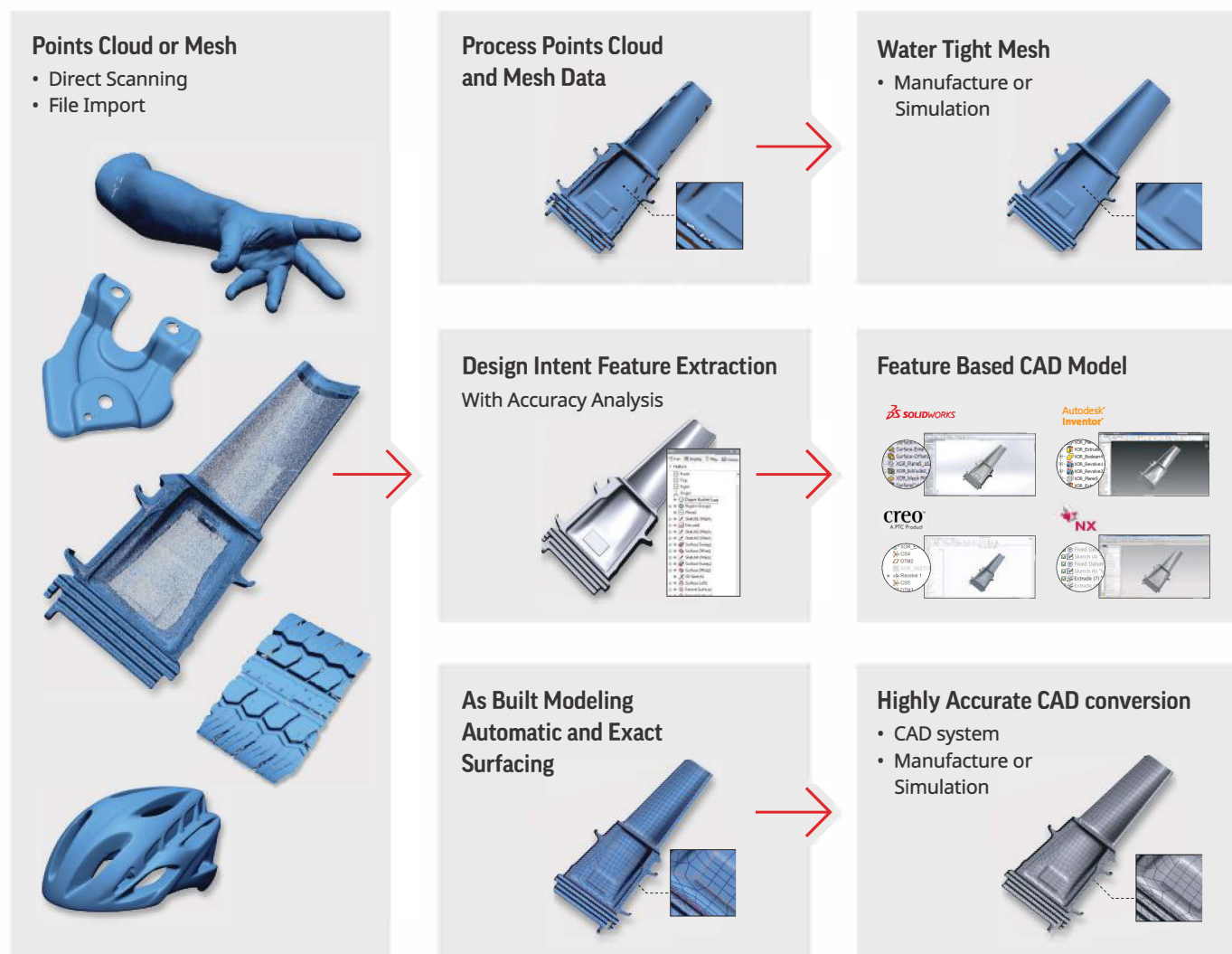

Why Geomagic Design X?

- It supports leading 3D scanners in the world
- Allows you to import more than 60 file formats, including polygons, point clouds and CAD
- Professionally integrates and reconstructs cloud of points and triangle meshes
- Easy-to-use mesh repair tools deliver rapid hole filling, smoothing, optimizing, rewrapping and polishing tools such as Smart Brush
- Automatic surface creation based on data obtained from the 3D scanner
- Rapidly creates solids or surfaces like you would in CAD
- Automated Accuracy Analyzer™ tools compare and validate surfaces, solids and sketches against original scan data
- Live Transfer™ supports the output of data to the industry's leading CAD systems
- Industry-leading Exact surface creation converts organic shapes to precise CAD models
- Supports comprehensive export of neutral CAD or polygon files
- Allows you to create a professional visualization in collaboration with software KeyShot



Contact Information

Evatronix SA

scanners3d@evatronix.com

Phone: +48 33 499 59 11

www.evixscan3d.com



European Union
European Regional
Development Fund



About Evatronix

Evatronix SA is an authorized distributor of Geomagic Design X software and official commercial partner of 3D Systems. The company provides CAD, reverse engineering and inspection software as well as services. Evatronix SA is a producer of high-quality structured light 3D scanners under the brand of eviXscan 3D.